







CONVENÇÕES	QUANTITATIVO
 BOCA DE LOBO A EXECUTAR Ø 40 CM	3 UNIDADES
 TUBULAÇÃO A EXECUTAR Ø 40CM	121 M
 BOCA DE LOBO EXISTENTE Ø 40 CM	
 TUBULAÇÃO EXISTENTE Ø 40 CM	
 CURVAS DE NÍVEL	
 CANTEIRO EXISTENTE	



BOCA DE LOBO PARA TUBO Ø 40 CM
Sem escala

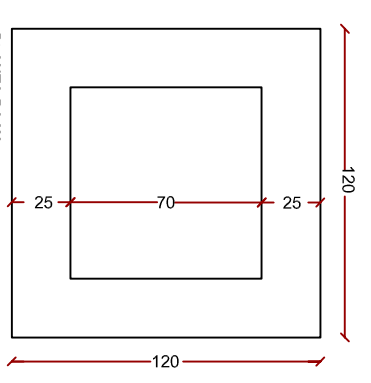
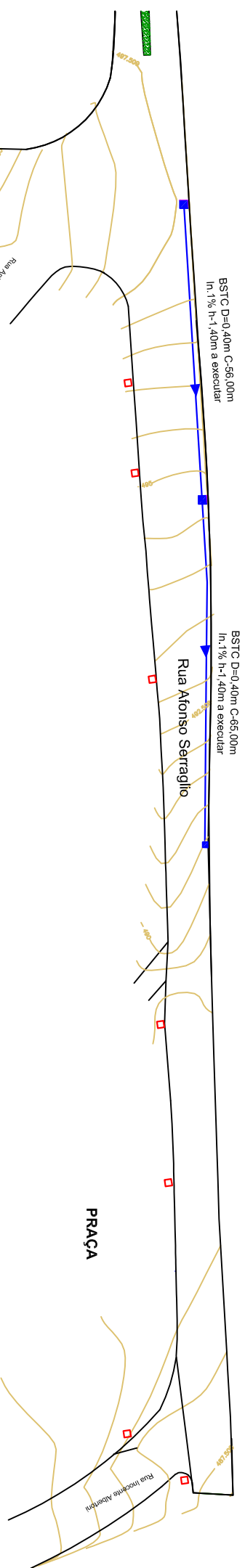
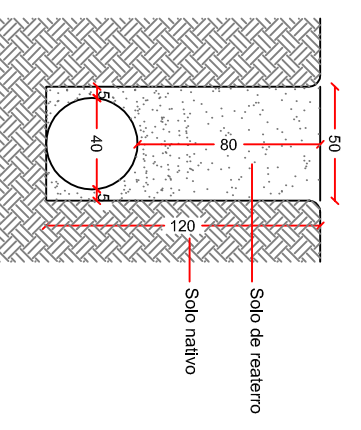
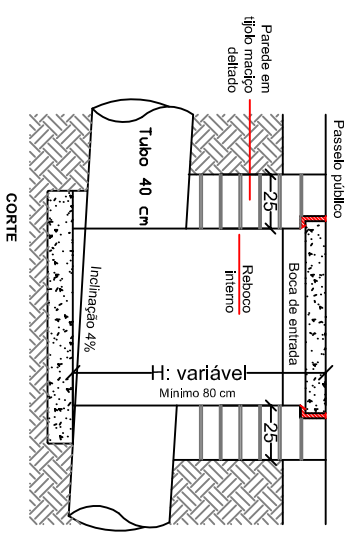

VALA SIMPLES
Esc. 1:50

Direnge
Construções e Projetos Ltda.

Rua Torres Gonçalves, 294 - Encimim/RS
Fone/Fax: 54 3522-1980 - email: direnge@viva-rs.net

PROJETO DE PAVIMENTAÇÃO ASFALTICA EM RUAS DA CIDADE

ENGENHEIRO: RUA AFONSO SERRAGLIO
ITATIBA DO SUL / RS.

PROPRIETÁRIO: MUNICÍPIO DE ITATIBA DO SUL

RESPONSÁVEL TÉCNICO: MARLEI SALETE OGRODOWSKI
Engª CMI - CREA/RS 83890

DRENAGEM PLUVIAL

FEVEREIRO/2016
02/03
DANIELA
Escala 1:500